

TROLLEY CLAMP

- A quick fit trolley easy to use on jobbing sites.
- This trolley is often used for securing lifelines.
- For all kinds of hoisting jobs.
- No tiresome adjustment of the wheel gauge by means of spindles with nuts and washers, no just turn the handle to open the wheel s and reverse this handle to close.
- Block the handle by the handle with counter nut.
- High grade sealed, maintenance free and lift time greased ball bearings.
- Strong flanged wheels with fine machined conical race.
- Anti-drop bars.
- Light weight.

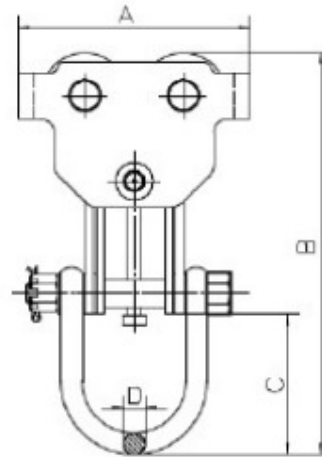
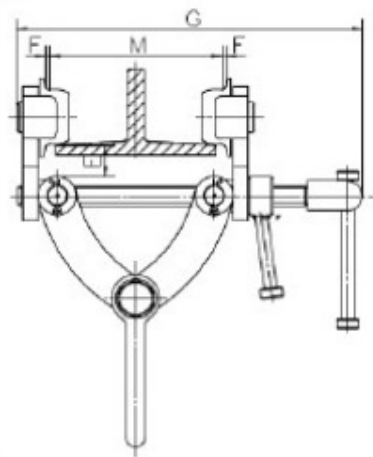

Rated Load (kg)		500	1000	2000	3000	5000
Test Load (Kn)		6.13	14.71	29.42	44.13	61.29
Min. Curve Radius (m)		1.1	1.1	1.3	1.4	1.5
Main Dimensions (mm)	A	174	174	280	345	395
	B	263-324	263-324	339-387	374-439	450-528
	C	105	105	111	127	135
	D	ø 16	ø 16	ø 22	ø 27	ø 35
	E	25.4	25.4	25.4	26	81
	F	(≈ 3)				
	G	336	340	340	345	465
I-beam Width Range (mm)	M	64-203	64-203	76-203	76-203	100-305
Net Weight (kg)		6	7	19.5	32	53